

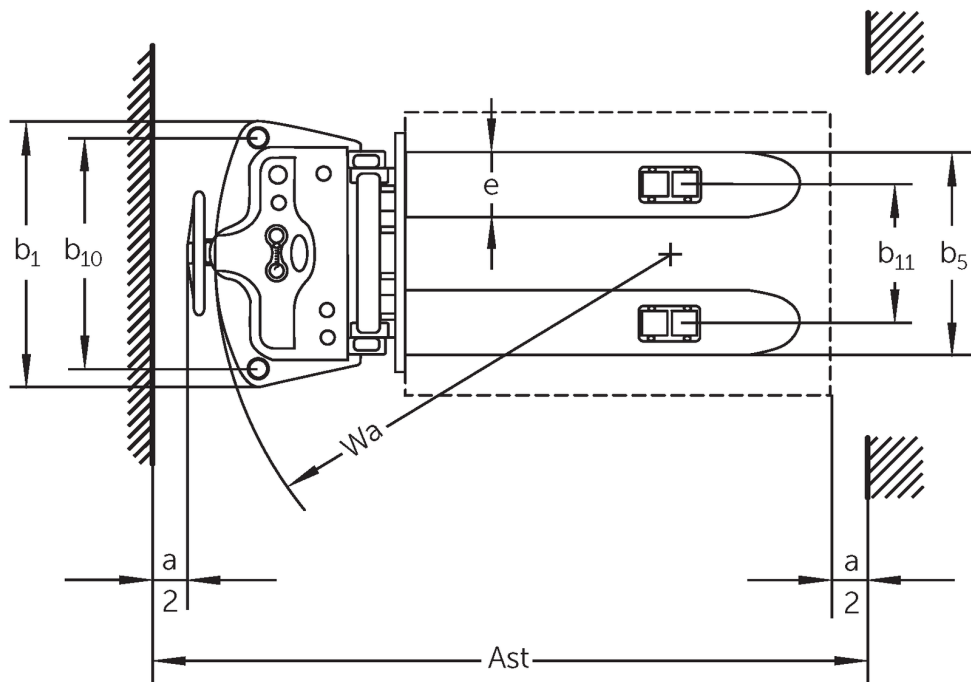

## **Electric hand stacker** **HC 110**

**Lift height: 1600-3000 mm / Load capacity: 1000 kg**

# HC 110

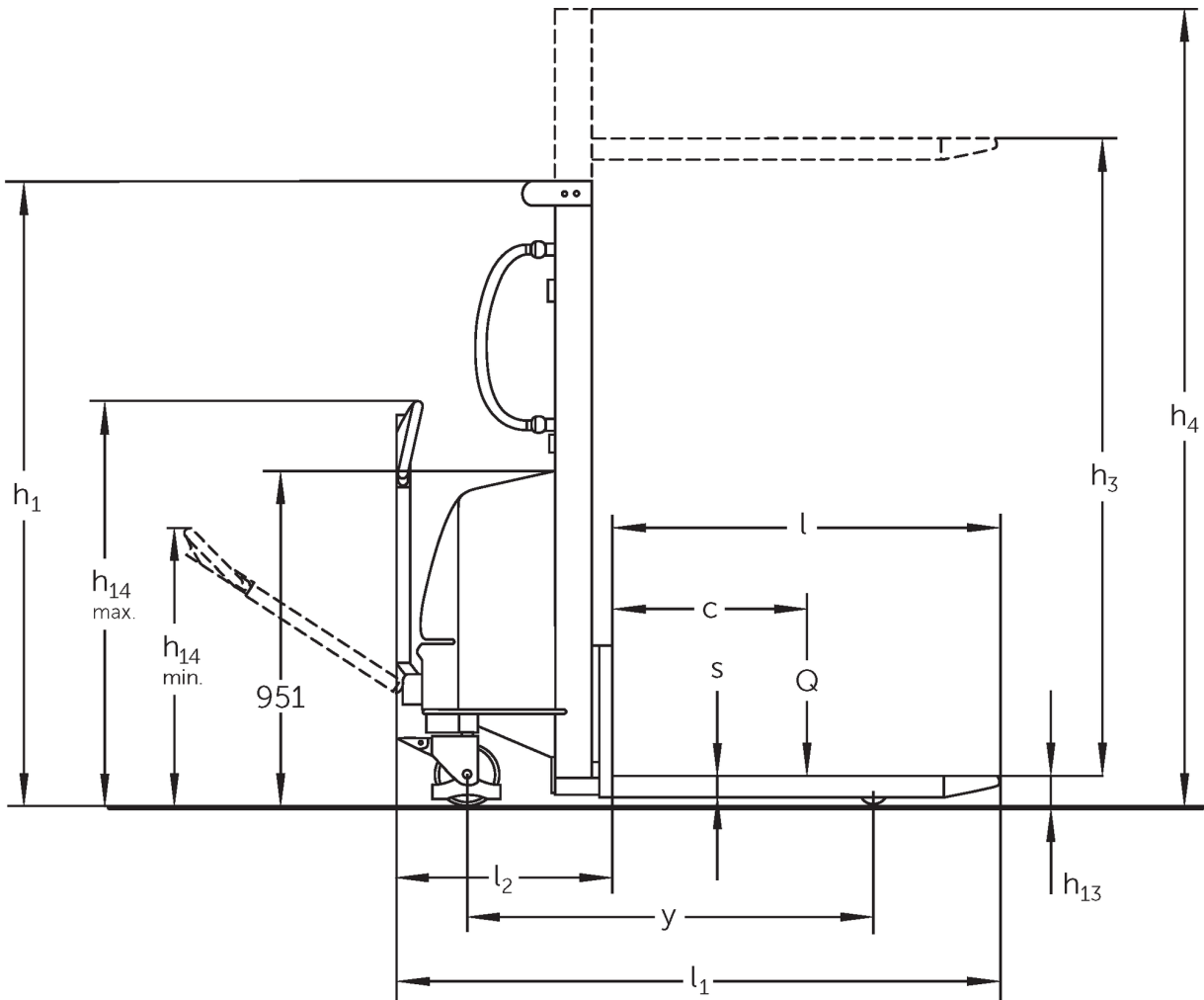

# VDI table

Stand-on: 10/2020

Characteristic	1.1	Manufacturer (abbreviated description)		Jungheinrich		
	1.2	Manufacturer's type designation		<b>HC 110</b>		
	1.3	Drive		Manual		
	1.4	Operation		Pedestrian		
	1.5	Load capacity/load	Q kg	1000		
	1.6	Load centre distance	c mm	600		
	1.9	Wheelbase	y mm	1210		
Weights	2.1.1	Service weight (incl. battery)	kg	348	435	450
	2.2	Axle load laden front/rear	kg	400 / 948	443 / 992	454 / 996
	2.3	Axle load unladen front/rear	kg	242 / 106	306 / 129	323 / 127
Wheels/suspension system	3.1	Tyres		C, N		
	3.2	Tyre size, front		Ø 180 x 50		
	3.3	Tyre size, rear		Ø 74 x 93		
	3.5	Wheels, number front/back (x=driven)		2/2		
	3.6	Tread width, front	b <sub>10</sub> mm	680		
	3.7	Tread width, rear	b <sub>11</sub> mm	400		
	Basic dimensions	4.2	Retracted mast height (h <sub>1</sub> )	h <sub>1</sub> mm	1980	1830
4.4		Lift (h <sub>3</sub> )	h <sub>3</sub> mm	1600	2500	3000
4.5		Extended mast height (h <sub>4</sub> )	h <sub>4</sub> mm	1980	3070	3570
4.9		Height of tiller handle in drive position min./max.	mm	790 / 1156		
4.15		Height, lowered	h <sub>13</sub> mm	85		
4.19		Overall length	l <sub>1</sub> mm	1720		
4.20		Length including fork shank	l <sub>2</sub> mm	620		
4.21.1		Overall width	b <sub>1</sub> mm	777		
4.22		Fork dimensions	s/e/l mm	60 / 180 / 1100		
4.25		Width across forks	b <sub>5</sub> mm	570		
4.34		Aisle width (pallet 1000x1200 sideways)	A <sub>st</sub> mm	2145		
4.34.1		Aisle width (pallet 800x1200 length)	A <sub>st</sub> mm	2175		
4.35		Turning radius	W <sub>a</sub> mm	1335		
Performance data	5.2	Lift speed laden/unladen	m/s	0.08 / 0.11		
	5.3	Lowering speed laden/unladen	m/s	0.19 / 0.13		
E-motor/ Electronics	6.2	Lift motor, performance with S3	kW	1.5		
	6.4	Battery voltage/nominal capacity	V / Ah	12 / 150		
	6.5	Battery weight	kg	45		
	6.6	Energy consumption according to VDI cycle	kWh/h	0		

- This data sheet according to VDI guideline 2198 only states the technical values of the standard truck. Different tyres, other masts, additional equipment etc. may result in different values.

The German production facilities in  
Norderstedt, Moosburg and Landsberg  
are certified.

ISO 9001  
ISO 14001

Jungheinrich fork lift trucks meet  
European safety requirements.



 **JUNGHEINRICH**

The Jungheinrich logo, featuring a red upward-pointing arrow integrated into the letter 'J', followed by the brand name 'JUNGHEINRICH' in a bold, black, sans-serif font.