

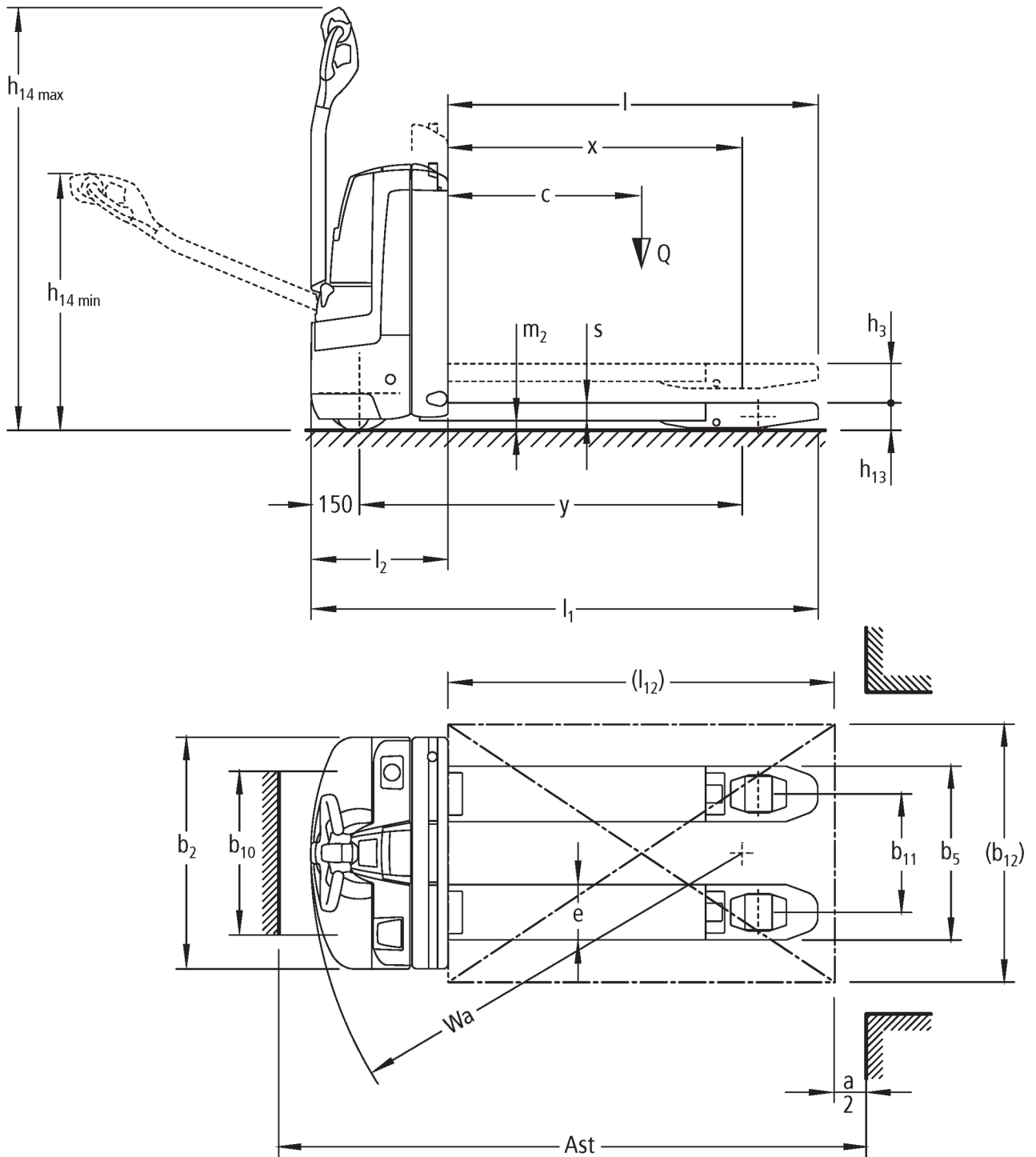

## **Electric pedestrian pallet truck** **EJE 112i / 114i**

**Lift height: 122 mm / Load capacity: 1200-1400 kg**

# EJE 112i / 114i



# VDI table

Stand-on: 10/2020

Characteristic	1.1	Manufacturer (abbreviated description)		Jungheinrich		
	1.2	Manufacturer's type designation		<b>EJE 112i</b>	<b>EJE 114i</b>	
Characteristic	1.3	Drive		Electric		
	1.4	Operation		Pedestrian		
	1.5	Load capacity/load	Q kg	1200	1400	
	1.6	Load centre distance	c mm	600		
	1.8	Load distance, centre of drive axle to fork	x mm	911		
	1.9	Wheelbase	y mm	1186		
	Weights	2.1.1	Service weight (incl. battery)	kg	315	
		2.2	Axle load laden front/rear	kg	557 / 958	625 / 1090
		2.3	Axle load unladen front/rear	kg	246 / 69	
Wheels/suspension system	3.1	Tyres		PU/PU		
	3.2	Tyre size, front		Ø 230 x 70		
	3.3	Tyre size, rear		Ø 85 x 110 / 85 x 85		
	3.4	Additional wheels		Ø 100 x 40		
	3.5	Wheels, number front/back (x=driven)		1x 2/2		
	3.6	Tread width, front	b <sub>10</sub> mm	508		
	3.7	Tread width, rear	b <sub>11</sub> mm	368		
Basic dimensions	4.4	Lift (h <sub>3</sub> )	h <sub>3</sub> mm	122		
	4.9	Height of tiller handle in drive position min./max.	mm	797 / 1313		
	4.15	Height, lowered	h <sub>13</sub> mm	85		
	4.19	Overall length	l <sub>1</sub> mm	1575		
	4.20	Length including fork shank	l <sub>2</sub> mm	425		
	4.21.1	Overall width	b <sub>1</sub> mm	720		
	4.21.2	Overall width	b <sub>2</sub> mm	720		
	4.22	Fork dimensions	s/e/l mm	55 / 172 / 1150		
	4.25	Width across forks	b <sub>5</sub> mm	540		
	4.32	Ground clearance centre of wheelbase	m <sub>2</sub> mm	30		
	4.34	Aisle width (pallet 1000x1200 sideways)	Ast mm	1762		
	4.34.1	Aisle width (pallet 800x1200 length)	Ast mm	1855		
	4.35	Turning radius	W <sub>a</sub> mm	1370		
Performance data	5.1	Travel speed laden/unladen	km/h	6 / 6		
	5.2	Lift speed laden/unladen	m/s	0.04 / 0.05		
	5.3	Lowering speed laden/unladen	m/s	0.05 / 0.05		
	5.7	Gradeability laden/unladen	%	10 / 20		
E-motor/Electronics	6.1	Drive motor, performance S2 60 min	kW	1		
	6.2	Lift motor, performance with S3	kW	1.2		
	6.3	Battery according to DIN 43531/35/36		no		
	6.4	Battery voltage/nominal capacity	V / Ah	24 / 40		
	6.5	Battery weight	kg	14		
	6.6	Energy consumption according to VDI cycle	kWh/h	0		
Other	8.1	Type of drive control		AC		
	10.7	Sound level as per EN12053, operator's ear	dB (A)	70		

- This data sheet according to VDI guideline 2198 only states the technical values of the standard truck. Different tyres, other masts, additional equipment etc. may result in different values.

The German production facilities in  
Norderstedt, Moosburg and Landsberg  
are certified.

ISO 9001  
ISO 14001

Jungheinrich fork lift trucks meet  
European safety requirements.



 **JUNGHEINRICH**

The Jungheinrich logo, featuring a red upward-pointing arrow integrated into the letter 'J', followed by the brand name 'JUNGHEINRICH' in a bold, black, sans-serif font.